



# "Electriflame"

## Wall Hung Electric Fires

### Packing Check list

<b>Package 1</b>	1 off	Electric fire
	1 off	Wall fixing plate
	1 off	Decorative light kit - optional
	1 off	Remote control handset
	2 off	AAA batteries
	1 off	Instructions manual
<b>Package 2</b>	1 off	Fascia

**THIS INSTRUCTION BOOKLET MUST BE LEFT WITH THE USER**

## **INSTALLATION INSTRUCTIONS**

**This fire must be installed by a qualified, competent installer.**

### **A. Location**

1. The fire must not be in contact with any combustible materials.
2. The heater, which is located at the base of the fire, must be a minimum of 400mm away from any combustible material.
3. It is important that the wall on to which the fire is to be installed is of sound construction. All fixings must be suitable for the type of wall, must be secure to the wall and capable of supporting the weight of the fire and the fascia.
4. The fire must not be installed in an area where there is restricted air flow around the fire.
5. This appliance is for indoor installation only and is not designed to be installed outside. The appliance must be kept away from any source of damp or moist conditions. Avoid any close contact with water.
6. If there is any doubt regarding the suitability of the installation site contact your supplier.
7. These fires produce heat consequently it is important to ensure that a suitable wall covering is selected behind and around the appliance.

### **B. Fixing To Wall**

**IT IS IMPORTANT TO READ THROUGH THE FIXING INSTRUCTIONS BEFORE COMMENCING THE INSTALLATION.**

1. Select the position of the fire on the wall to which it is to be mounted. Draw a level horizontal line on the wall at the required height. This line will correspond to the top of the appliance so it is important to allow for the extra height of the fire front.
2. Mark the central line of the fire on to the horizontal line
3. When the Celsi Electriflame product is unpacked unscrew the four transit screws holding the fixing plate to the back of the fire. Place the Fixing Plate supplied to the horizontal line and line up the central "V" cut out with you centre line. See Figure 1.
4. Mark out at least four of the fixing holes through the fixing plate to the wall. It is imperative that the fixing plate is secured firmly to the wall. See Figure 1.
5. If the wall is of a sound masonry construction the fixing holes should be drilled with an 8mm masonry drill. Then appropriately sized screws and rawl plugs should be used to secure fixing if achieved if this is not so additional fixings will be required, consult a qualified engineer.
6. If the fire is to be installed on a studded wall, the fixing screws must be located through any of the fixing holes in the fixing plate where they are inserted directly into the studding. It is important in this instance that the fixings are evenly distributed across the fixing plate and the plate must be secure to the wall.

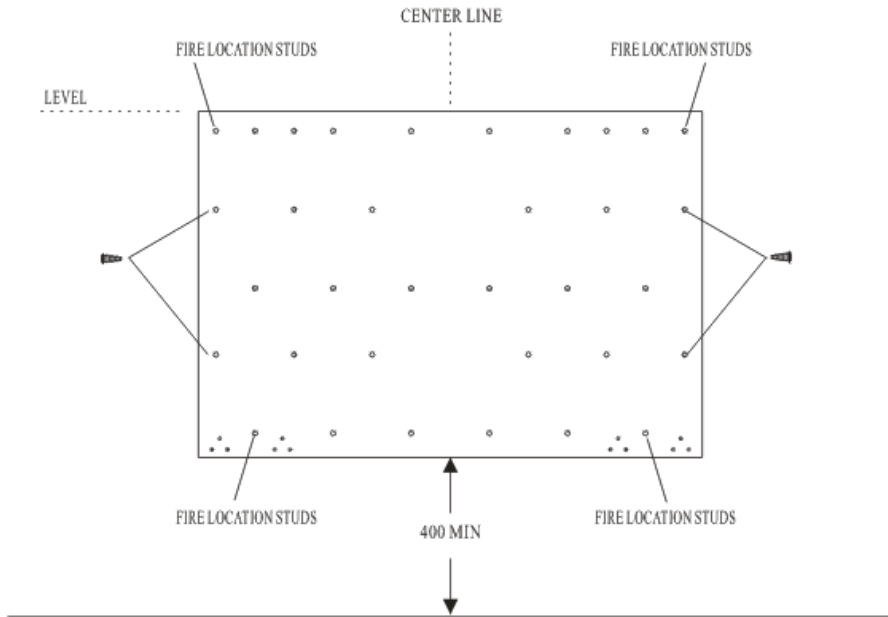

FIG 1

7. If a firm fixing is not achieved it may be necessary to install extra support to the studding. It is most important that the fixings are firm and solid and that the structure is capable of taking the load. Plasterboard fixings are not recommended.
8. The fixing plate has four location studs, one at each corner of the plate. See figure 1.
9. Lift up the fire and offer the keyhole slots situated on the back of the fire (figure 2) to the location studs on the fixing plate. A gentle downward pressure should be applied. Make sure the all of the studs have been located into the top section of each keyhole fixing slot. (See figures 3 & 4)



FIG 2

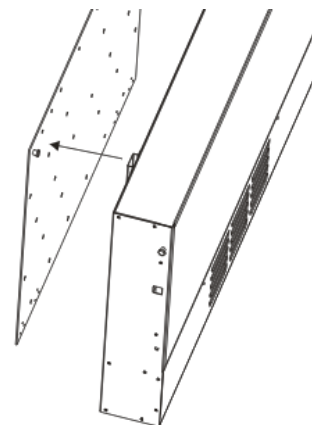

FIG 3

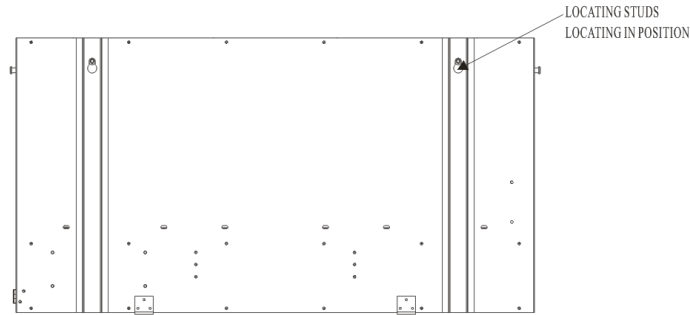

FIG 4

### C. Electrical Work

#### **THIS PRODUCT MUST BE EARTHED**

1. A mains electrical point must be sited close to the fire. Ensure it is in reach of fires mains flex and plug. Always ensure that it is possible to remove the fire at a later date, if required. **DO NOT INSTALL THE FIRE WHERE THE HEATER IS DIRECTLY ABOVE THE PLUG SOCKET.** The heat outlet is located in the centre at the base of the fire.
2. If the mains socket is required to be concealed this can be sited adjacent to the right hand side of the fire and behind the fascia.
3. Should the fire be connected directly into the mains supply a fused switch spur with a 13 amp fuse must be fitted. It is imperative that the power supply is capable of handling a load of 2000 watts (2kW). Allow sufficient flex to enable the fire to be removed from the wall if required by the disconnection of the kettle plug.
4. If the supply cable is damaged in any manner it **MUST** be replaced.
5. Do not connect the appliance to an extension lead.
6. The fire must not be modified from the manufacturers specification in any way and the appliance must only be used for the purpose recommended by the manufacturer.
7. If the fire shows any signs of damage it is important that it is examined by a qualified person.
8. Please observe these instructions as failure to do so may result in electric shock or other inquiry.
9. Check the technical specification.
10. Always ensure that all electrical work complies with the relevant Building Regulations and the Electrical Code of Practice. All electrical work should be carried out by a qualified electrician.
11. Do not install a time switch to operate the appliance.
12. If in any doubt contact your supplier or a qualified electrician.

#### D. Fixing The Facia

1. On each side of the fire there are one locating stud on the upper part of the side and one screw hole on the lower part of the side (Figure 5).

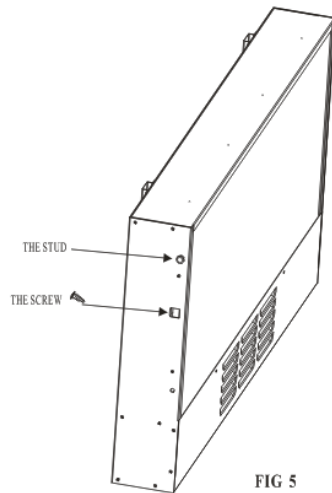

2. On the back of the facia there are two brackets which hook over these studs.
3. Lift the facia up to the fire. Two people may be required to carry out this installation. Then lower the facia into place so that the brackets on the rear of the facia locate either side of the studs on the upper part of each side of the fire. Then screw the lower part of the bracket into the screw holes on each lower part of the engine's side. (Figure 6)

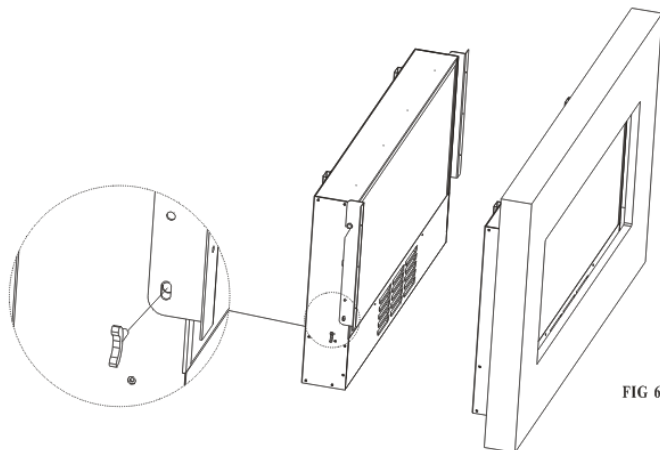

**THE INSTALLER SHOULD EXPLAIN TO THE CUSTOMER FULLY HOW TO OPERATE THE APPLIANCE.**

## OPERATING INSTRUCTIONS

**Please read these instructions carefully before attempting to use the appliance and retain for future use.**

1. When the fire is in operation certain areas will get hot. Caution must be taken to avoid being burned.
2. The fire must not be switched on if volatile vapors are present in the room
3. Children must be supervised around the fire.
4. Do not obstruct the air flow around the appliance.
5. Ensure that the fire is switched off at the mains before cleaning or carrying out any maintenance work.
6. When the fire is not in use it should be switched off at the mains supply.
7. Do not push any objects through the vent of the fire as this may result in an electric shock or could cause a fire.
8. This appliance is not intended for use by persons (including children) with reduced physical, sensory or mental capabilities, or lack of experience and knowledge, unless they have been given supervision or instruction concerning the use of the appliance by a person responsible for their safety.
9. In order to avoid overheating, do not cover the heater.
10. Make sure the heater is not located immediately below a socket outlet.
11. This heater is not equipped with a device to control the room temperature. Do not use this heater in small rooms when they are occupied by persons not capable of leaving the room on their own, unless constant supervision is provided.

### Control Panel on Fire

The control panel is located behind the louvers. Lifting the right hand side will raise the louvers. The centre of the louvers will get hot when the heater is switched on (see figure 9)

- A On / Off Isolating Switch
- B Flame Effect Dimmer Switch
- C Low Heat 750W
- D High Heat 1500W

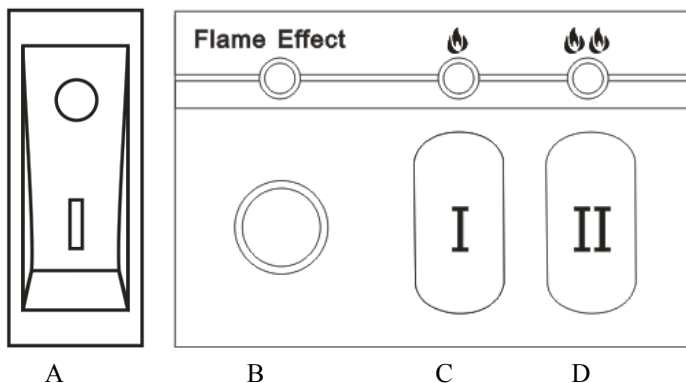

**Figure 7**

## **Remote Control**

Prior to use the remote control handset requires that the insertion of 2 off AAA batteries, as supplied. (Figure 8)

Remove the cover on the rear of the remote handset by sliding backwards. Install the batteries as shown and then slide the cover back into the original position.

To enable the remote control to function the power to the fire must be switched on.

At a distance of 1.5 metres to 2 metres point the remote control handset directly towards the bottom right hand side of the fire. (Figure 9)

- A. On/Off Switch
- B. Flame Effect adjuster To operate, press one to five times to commence the cycle of 4 different brightness levels. Press a fifth time to shut down the flame effect.
- C. Low Heat
- D. High Heat
- E. LED decorative lights ( selected models only)



**Figure 8**

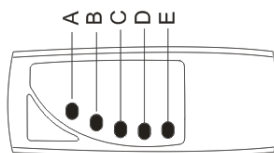

**Figure 9**

## **WARRANTY**

In the unlikely event of a problem occurring due to a manufacturing fault within 24 months from the date of purchase of the appliance it will be repaired or replaced free of charge.

**The warranty does not cover consumable items such as fuses which have a limited lifespan.**

If a problem should occur, the nature of the problem together with the date of purchase and installer information should be immediately reported to the retailer that the appliance was purchased from. Proof of purchase will be required so the original invoice should be retained.

## **TECHNICAL SPECIFICATION**

<b><u>Model</u></b>	<b><u>Small</u></b>	<b><u>Large</u></b>
Dimensions of fire only	650mm x 450mm x 100mm	850mm x 450mm x 100mm
Dimension of fascia	Sizes vary - see sales literature	
Power supply	220V - 230V AC 50HZ	220V - 230V AC 50HZ
General power	23W to 1500W	28W to 1500W
Heater power	750W to 1500W	750W to 1500W
Flame effect	23W	28W

**Heater has an over heating power cut off safety feature.**

Correct Disposal of this product	
	This marking indicates that this product should not be disposed with other household wastes through the EU. To prevent possible harm to the environment or human health from uncontrolled waste disposal, recycle it responsibly to promote the sustainable reuse of material resources. Contact your local council for advice.

## **MAINTENANCE INSTRUCTIONS**

### **Cleaning the Fire**

Switch off the power to the fire and allow it to cool before cleaning.

Use a soft damp (not wet) cloth.

Household Glass Cleaner can be used on the Fire Glass

**Part No. B-156360**



**Issue 2**

**BFM Europe Ltd  
Gordon Banks Drive  
Trentham Lakes  
Stoke-on-Trent  
ST4 4TJ**

**Telephone (General Enquiries) 01782 339000**

**Telephone (Service) 0844 7700169**